



## The Devonshire

Imagery Homes is proud to offer the Devonshire, a Craftsman Style split bedroom ranch with 2,863 square feet of living space. The rich exterior finishes include stone, cedar shake shingles, and decorative gable brackets.

You are welcomed through an inviting covered entryway into a dramatic foyer with its 12' ceilings and arched top transom window. Beneath your feet you will find hardwood flooring that extends from the foyer into the dining room, kitchen, and dinette.

Just off the foyer is an elegant dining room with a 11 foot high coffered ceiling, crown moulding, built-in china cabinets, and a butler's pantry with granite counter tops.

From the foyer, you enter the impressive great room through an arched opening that reveals the 12' high ceiling, large windows with transoms, gas fireplace, and built-in maple cabinetry.

The kitchen and large dinette feature maple cabinets with a distinctive crown moulding, wraparound snack bar, work island, large walk-in pantry, built-in appliances and granite countertops. Off the kitchen is a large dinette with cathedral ceilings and large floor to ceiling windows.

The master bedroom has an 11' coffered ceiling, crowned moulding, and his and her walk-in closets with built-in shelving. The luxurious master bath has a large whirlpool tub, oversized walk-in tile shower, his & her vanities with quartz countertops, and ceramic tile flooring with a radiant floor warming system.

A spacious utility room contains a built-in sink, maple cabinets for added storage. The mud room is conveniently located off the garage and includes a large coat closet, storage lockers and ceramic tile floors.

It is the mission of Imagery Homes, to provide its customers with distinctive high quality homes. This is evident with the exceptional finishes and quality construction found in the Devonshire.

**Imagery Homes, LLC**  
**1105 Michael Drive, Brookfield, Wisconsin 53045**  
**Phone: 262-370-7121 Fax: 262-796-8029**  
**Or Visit Us On The Web: [www.imageryhomes.com](http://www.imageryhomes.com)**

## Features Included in the Devonshire:

### Foyer

- Simpson wood entry door with sidelights and transom window
- 12' coffered ceiling with crown moulding
- Full view aluminum combination door

### Formal Dining

- 11' Coffered ceiling
- Crown moulding
- Built-in china cabinet
- Butlers pantry with granite countertops

### Kitchen/Dinette

- Maple cabinets with roll-out shelves
- Granite countertops with raised snack bar
- Work island
- Kohler™ stainless steel sink
- Walk-in pantry w/automatic light
- Under cabinet lighting
- Built-in stainless steel appliances

### Family/Great Room

- Twelve foot ceilings
- Large transom windows
- Direct vent gas fireplace with tile face and wood surround
- Built-in bookshelves and entertainment cabinet

### Master Bedroom Suite

- 11' coffered ceiling w/crowned moulding
- His & her walk-in closet with built-in shelving
- Large whirlpool tub with ceramic surround
- Oversized walk-in tile shower
- His & her vanity cabinets with quartz countertops
- Ceramic tile floor with radiant warming system

### Standard Features:

- Full basement, 9' poured concrete foundation walls with drain tile and sump pump
- TJI silent floor joist, Weyerhaeuser Structurwood Gold™ ¾" tongue and groove one piece floor system, glued, nailed, and screwed down
- 2 x 6 exterior walls 16" on center
- Tyvek™ Homewrap with taped seams
- Insulation: R5 foundation, R-21 walls (closed cell foam), R-50 blown attic

Size: 81'-0" x 62'-10"  
2,863 Sq. Ft.

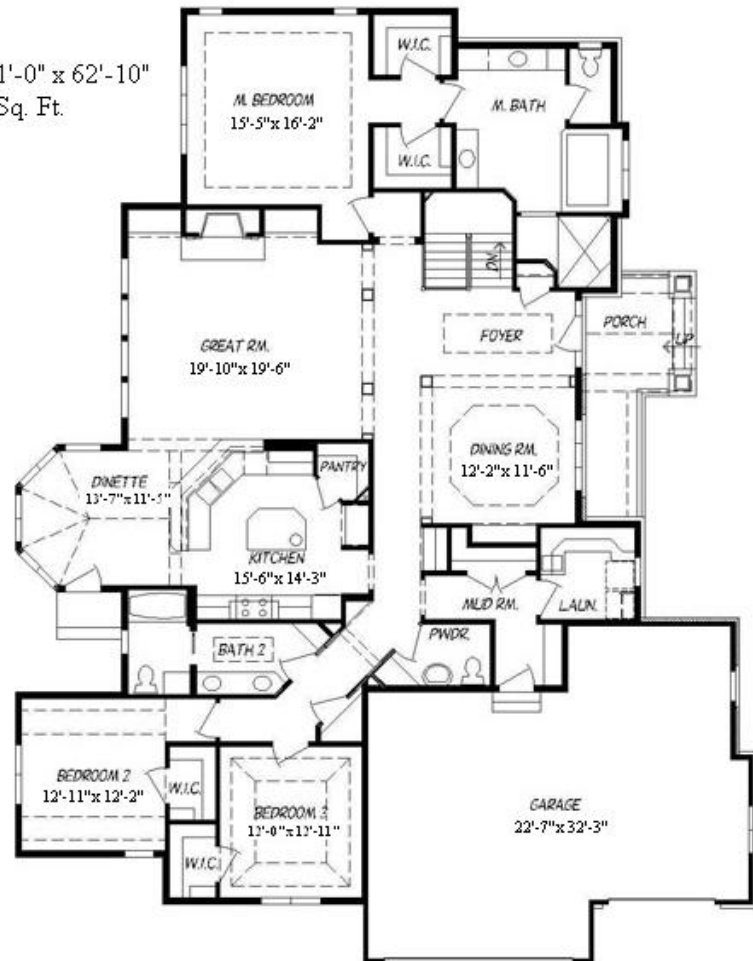

- Energy efficient Low "E" plus Argon gas filled Anderson™ 400 series casement windows and patio doors with internal grilles
- Exterior Materials: Stone and fiber-cement siding
- Cedar wrapped windows and corner boards
- GAF/Elk™ 30 year dimensional high-profile roofing shingle w/ice & water shield
- Exterior and interior painting/staining & caulking
- Dramatic 9' ceilings unless otherwise noted
- Three panel maple interior doors
- Maple wood 3 ½" case and 4 ¼" base trim
- Kohler™ kitchen sink and toilets
- Delta™ & Grohe™ faucets
- Insinkerator™ garbage disposal
- Refrigerator ice maker water line
- Drywall texture applied to all interior walls
- Insulated steel panel garage doors with openers and keyless entry
- Garage finished with insulation and drywall on ceiling and walls
- Seamless aluminum gutters w/4" downspouts
- Phone jacks in the kitchen and all bedrooms
- Cable jacks in the grt room and all bedrooms
- 200 Amp electric service
- Two (2) 65 gallon water heaters
- Bathroom tops: Quartz & Solid Surface
- Tub/Shower: cast iron w/tile surround

- Exhaust fans in all bathrooms
- Carrier™ high efficiency forced air furnace and central air conditioning (13 SEER)
- Three frost-proof exterior hose faucets
- Five exterior outlets
- Mirror allowance
- Schlage™ door levers
- Bathroom towel bars and paper holders
- Site preparation: permits, stake-out survey, gravel drive, erosion control fencing, garage gravel, grading
- Site clean-up and final cleaning

### Allowances:

Permits & Fees ....	\$2,000.00
Light fixtures .....	\$5,000.00
Carpeting .....	\$4,500.00
Wood Flooring ....	\$9,500.00
Countertops.....	\$10,000.00
Appliances .....	\$7,000.00

### Base Price: \$\*

\* Plus Lot & Lot Improvements